

DATI TECNICI / technical sheet	505/M
	armadietto vuoto/empty cabinet

cod. CAV505

MATERIALI / components

Armadietto in acciaio al carbonio, verniciato in epossipoliestere, cottura al forno 180°
2 ripiani fissi in acciaio, ante dotate ciascuna di tre ripiani fissi , serratura con chiave.

*White carbon steel PO2 Metal Cabinet enamelled with epoxy Polyester powder,
2 internal fixed metal shelves, with 3 fixed shelves on the doors and with lock and key.*



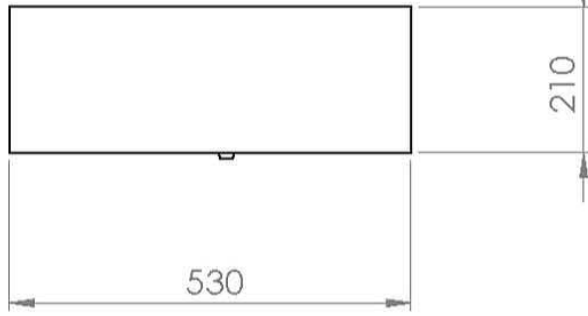
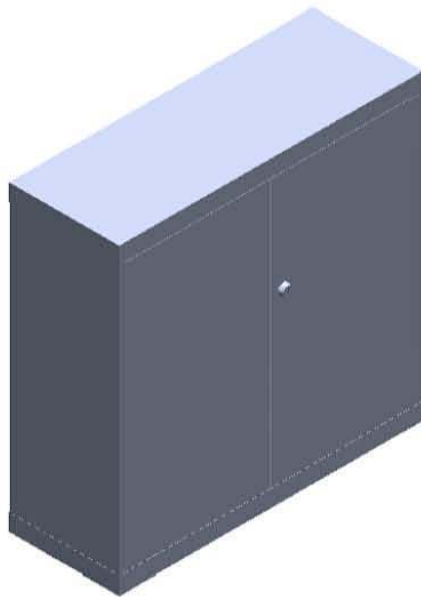
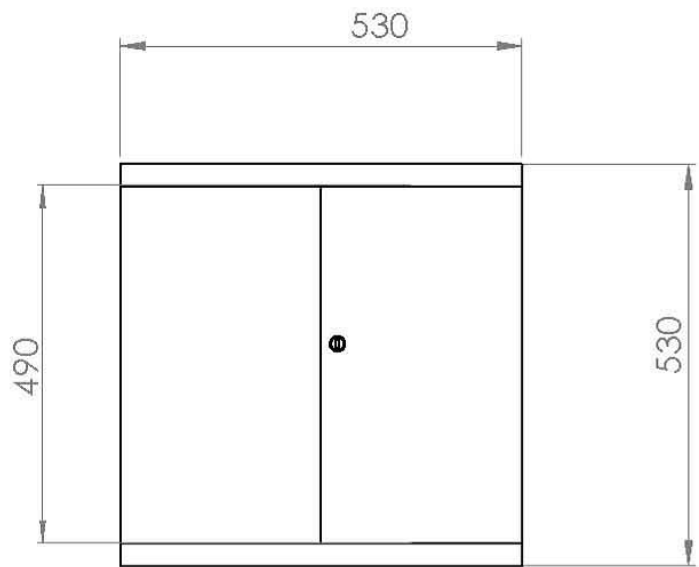
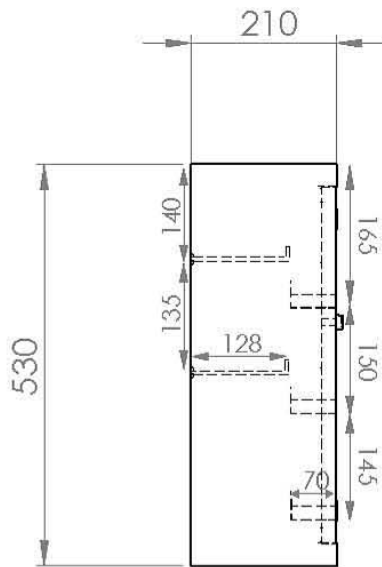

SE NON SPECIFICATO: QUOTE IN MILLIMETRI FINITURA SUPERFICIE: TOLLERANZE: LINEARE: ANGOLARE:		FINITURA: White epoxy polyester color		INTERRUZIONE BORDI NETTI		NON SCALARE DISEGNO		REVISIONE	
NOME		FIRMA		DATA		TITOLO: 505/M			
DISEG.		VERIF.		APPR.		PESO: weight 7,8 kg			
FABB.		Qual.		MATERIALE: sheet metal thickness 7/10		SCALA:1:10			
						FOGLIO 1 DI 1			

F
E
D
C
B
A

F
E
D
C
B
A

4 3 2 1

4 3 2 1